

# 10. ACCESSORIES & PARTS

ETL LISTED TO UL 471 standard and sanitation classified to NSF / We reserve the right to change specifications without prior notice. Non contractual pictures

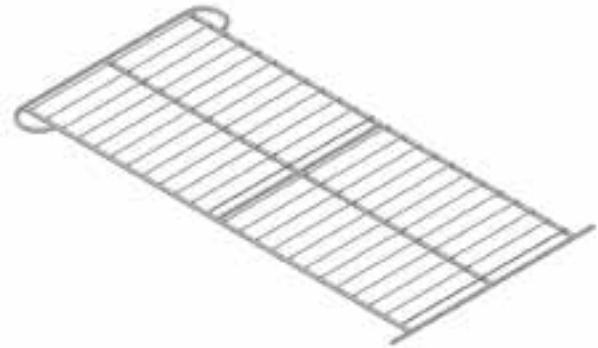



## SLIDES

CODE	DESCRIPTION	MODELS	PRICE \$
<b>STAINLESS STEEL SLIDES</b>			
GUIAUAN60	Slides 24-7/32"	All AN Models	\$88
GUIA503X15 + GUIA503X20	Slides 21-21/32"	MPG Models	\$41
GUIA503MR01	Slides MR LEFT	MR	\$47
GUIA503MR02	Slides MR RIGHT	MR	\$47
10GB7060	Slides 26-55/64"		\$44
10GB7061	Slides 26-55/64"		\$44
10GB7060 + 10GB7061	Slides 26-55/64"	All AGB Models	\$89
3200X0226	Slides kit 15-1/2"	EVV23Retro, EVV494SDRetro, MR76Retro	\$23
3200X0225	Slides kit 15-1/2" + 17-1/4"	EVV23Retro, EVV494SDRetro, MR76Retro	\$27

## SHELVING

CODE	DESCRIPTION	MODELS	PRICE \$
<b>PLASTIC COATED WIRE SHELVES</b>			
502X14	GN 2/1 Shelf 20-7/8" x 25-19/32"	All AN, AGB Models	\$123
502X12	GN 1/1 Shelf 12-51/64" x 25-19/32"	All AGN, MPG Models	\$93
502X73	Shelf 22-29/64" x 17-13/64"	All UC27, UC72 Models	\$114
502X74	Shelf 21-1/4" x 17-13/64"	All UC48, UC 72 Models	\$114
502X75	Shelf 27-19/64" x 17-13/64"	All UC60 Models	\$108
502X77	Shelf 20" x 25-19/32"	All MR Models	\$120
3200X0191	Shelf 1-3/4" x 20-9/32"	EVV494SDRetro, MR76Retro	\$84
502X82	Shelf 24" x 18-5/16"	All ERV Models	\$112
502X83	Shelf 19-3/16" x 18-5/16"	ERV60IISD, ERV60IIGD, ERV84IISD, ERV84IIGD	\$109

## 10. ACCESSORIES & PARTS

# ACCESSORIES & PARTS

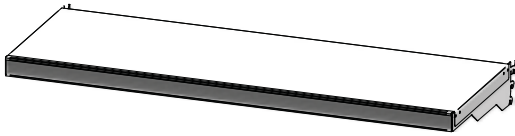

### Plastic-Coated Extra-Dense Wire Shelves

502X60	GN 2/1 Extra-Dense Shelf 20-7/8" x 25-19/32"	All AN_CR, AGB_CR Models	\$147
502X62	GN 1/1 Extra-Dense Shelf 12-51/64" x 25-19/32"	All AGN_CR Models	\$111

### STAINLESS STEEL WIRE SHELVES

502X58	GN 2/1 Stainless Steel Shelf 20-7/8" x 25-19/32"	All AN, AGB Models	\$219
502X46	GN 1/1 Stainless Steel Shelf 12-51/64" x 25-19/32"	All AGN, MPG Models	\$162
502X78	Stainless Steel Shelf 20" x 25-19/32"	All MR Models	\$221
502X47	Stainless Steel Shelf 23-5/8" x 15-3/4"	All VC Models	\$183

### MEZZANINES SHELVES

BAZM09400	Mezzanine Shelf Air Curtains 938	All EML 9 Models	\$301
BAZM09400 inox	Mezzanine Shelf Air Curtains 938 stainless steel	All EML 9 Models	\$508
BAZM12400	Mezzanine Shelf Air Curtains 1250	All EML 12 Models	\$361
BAZM12400 inox	Mezzanine Shelf Air Curtains 1250 stainless steel	All EML 12 Models	\$365
2 X BAZM09400	Mezzanine Shelf Air Curtains 1875	All EML 18 Models	\$602
2 X BAZM09400 inox	Mezzanine Shelf Air Curtains 1875 stainless steel	All EML 18 Models	\$1,016

## SHELF CLIPS

CODE	DESCRIPTION	MODELS	PRICE \$
506X08	Stainless Steel Shelf Clips UC	All UC Models, All ERV Models	\$7

## TRAY DIVIDER

CODE	DESCRIPTION	MODELS	PRICE \$
------	-------------	--------	----------

### PLASTIC COATED TRAY DIVIDER

502X21	Plastic coated tray divider AN, AGN	AN49, AN49BT, AN67, AN67BT, AN49MX, AGN602, AGN602BT, AGN602MX	\$76
502X23	Plastic coated tray divider AGB	AGB49, AGB49BT, AGB23-2, AGB49-4	\$73

### PLASTIC-COATED EXTRA-DENSE TRAY DIVIDER

502X41	Plastic-coated extra-dense tray divider AN, AGN	AN49CR, AN67CR, AGN602CR	\$103
502X63	Plastic-coated extra-dense tray divider AGB	AGB49CR, AGB49BT	\$127

### STAINLESS STEEL TRAY DIVIDER

502X52	Stainless Steel tray divider AN, AGN	AN49, AN49BT, AN67, AN67BT, AN49MX, AGN602, AGN602BT, AGN602MX	\$148
502X67	Stainless Steel tray divider AGB	AGB49, AGB49BT, AGB23-2, AGB49-4	\$156

ETL LISTED TO UL 471 standard and sanitation classified to NSF / We reserve the right to change specifications without prior notice. Non contractual pictures

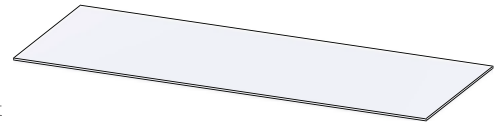

Glass shelf kit



GARNISH RACK



Rear sliding doors

## GARNISH RACK

CODE	DESCRIPTION	MODELS	PRICE \$
JPTMR 41	Garnish rack with catch pan	MR 41 EN 2 racks	\$630
JPTMR 67	Garnish rack with catch pan	MR 67 EN 3 racks	\$945
JPTMR 93	Garnish rack with catch pan	MR 93 EN 4 racks	\$1,260
JPTMR 119	Garnish rack with catch pan	MR 119 EN 5 racks	\$1,575

## GLASS SHELF KIT (Display Cases)

CODE	DESCRIPTION	MODELS	PRICE \$
604M14	Glass top shelf 36-11/32" x 10-53/64"	VBR9R, VBR9FG	\$237
604M15	Glass bottom shelf 36-11/32" x 14-3/4"	VBR9R, VBR9FG	\$273
604M16	Glass top shelf 48-5/8" x 10-53/64"	VBR12R, VBR12FG	\$289
604M17	Glass bottom shelf 48-5/8" x 14-3/4"	VBR12R, VBR12FG	\$344
604M18	Glass top shelf 73-1/4" x 10-53/64"	VBR18R, VBR18FG	\$356
604M19	Glass bottom shelf 73-1/4" x 14-3/4"	VBR18R, VBR18FG	\$401
604M20	Glass top shelf 36-11/32" x 12-13/64"	VBR9SS	\$245
604M21	Glass middle shelf 36-11/32" x 15-3/8"	VBR9SS	\$284
604M22	Glass bottom shelf 36-11/32" x 17"	VBR9SS	\$307
604M23	Glass top shelf 48-5/8" x 12-13/64"	VBR12SS	\$306
604M24	Glass middle shelf 48-5/8" x 15-3/8"	VBR12SS	\$344
604M25	Glass bottom shelf 48-5/8" x 17"	VBR12SS	\$346
604M26	Glass top shelf 73-1/4" x 12-13/64"	VBR18SS	\$353
604M27	Glass middle shelf 73-1/4" x 15-3/8"	VBR18SS	\$363
604M28	Glass bottom shelf 73-1/4" x 17"	VBR18SS	\$373
604V380	Glass top shelf VAR12R	VAR12R	\$172
604V381	Glass top shelf VAR15R	VAR15R	\$374
604V382	Glass top shelf VAR18R	VAR18R	\$378
604V371	Glass top shelf VARAA90°	VARAA90°	\$393
604V372	Glass top shelf VARAC90°	VARAC90°	\$174

## REAR SLIDING DOORS

CODE	DESCRIPTION	MODELS	PRICE \$
PUEV12CT	Rear sliding doors VBC12R	VBC12R	\$435
PUEV15CT	Rear sliding doors VBC15R	VBC15R	\$588
PUEV18CT	Rear sliding doors VBC18R	VBC18R	\$732

## 10. ACCESSORIES & PARTS

# ACCESSORIES & PARTS



### FLAT LID

CODE	DESCRIPTION	MODELS	PRICE \$
JTAP14MR41 EN	Complete Flat Lid MR41 [1]	MR 41 EN	\$367
JTAP14MR67 EN	Complete Flat Lid MR67 [2]	MR 67 EN	\$629
JTAP14MR93 EN	Complete Flat Lid MR93 [2]	MR 93 EN	\$402
JTAP14MR119 EN	Complete Flat Lid MR119 [3]	MR 119 EN	\$715
TAP14MR3	Complete Lid MR model for 3 trays	MR	\$327
TAP14MR5	Complete Lid MR model for 5 trays	MR	\$355
TAP14MR6	Complete Lid MR model for 6 trays	MR	\$360
TAPUC27PF	Complete Lid UC27P [1]	UC27P	\$186
TAPUC48PF	Complete Lid UC48P [1]	UC48P	\$264
TAPUC60PF	Complete Lid UC60P [2]	UC60P	\$330
TAPUC72PF	Complete Lid UC72P [2]	UC72P	\$369
TAPUC27PMTF	Complete Lid UC27PMT [1]	UC27PMT	\$219
TAPUC48PMTF	Complete Lid UC48PMT [1]	UC48PMT	\$324
TAPUC60PMTF	Complete Lid UC60PMT [2]	UC60PMT	\$381
TAPUC72PMTF	Complete Lid UC72PMT [2]	UC72PMT	\$399

### CASTERS / LEGS

CODE	DESCRIPTION	PRICE \$
705X16	Black caster, 4" Diameter	\$62
705X17	Black caster, 4" Diameter, front locking	\$109
950A053	Black caster, 2" Diameter	\$76
950A281	Black caster, 2" Diameter, front locking	\$105
506X42	6" Adjustable feet	\$54
506X61	Adjustable feet	\$39

### LOCKS

CODE	DESCRIPTION	MODELS	PRICE \$
950A054	Lock 135 R-14	All AN, AGN, AGB Models	\$41
506X120	Right lock	All MR Models [Right door]	\$93
506X121	Left lock	All MR Models [Left door]	\$93
506X60	Lock Ref.: 2038	All ERV Models	\$93

ETL LISTED TO UL 471 standard and sanitation classified to NSF / We reserve the right to change specifications without prior notice. Non contractual pictures



## OVERSHELF KITS (SINGLE/DOUBLE)

CODE	DESCRIPTION	PRICE \$
<b>SINGLE OVERSHELVES [16" D X 20" H*]</b>		
ESTSUC27	Single Overshelf kit for UC27R / P / PMT / F / D	\$264
ESTSUC48	Single Overshelf kit for UC48R / P / PMT / F / D	\$354
ESTSUC60	Single Overshelf kit for UC60R / P / PMT / F / D	\$417
ESTSUC72	Single Overshelf kit for UC72R / P / PMT	\$474
ESTSMR41	Single Overshelf kit MR41 / EN / BT	\$324
ESTSMR67	Single Overshelf kit MR67 / EN / BT	\$447
<b>DOUBLE OVERSHELVES [16" D X 33" H*]</b>		
ESTDUC27	Double Overshelf kit for UC27R / P / PMT / F / D	\$479
ESTDUC48	Double Overshelf kit for UC48R / P / PMT / F / D	\$673
ESTDUC60	Double Overshelf kit for UC60R / P / PMT / F / D	\$788
ESTDUC72	Double Overshelf kit for UC72R / P / PMT	\$903
ESTDMR41	Double Overshelf kit MR41 / EN / BT	\$606
ESTDMR67	Double Overshelf kit MR67 / EN / BT	\$851

\*Indicates maximum height from countertop to shelftop.

Overshelf kits are available for undercounters, deep undercounters and prep tables (sandwich/salad, megatop and pizza). Height is adjustable in single and double overshelf kits. Made of heavy-gauge stainless steel.

## DRAWERS

CODE	DESCRIPTION	PRICE \$
JCAJ10MR442C	Kit of drawers MR41 / MR67 / MR93	\$1,428
JCAJ10GN1/2	Kit of drawers UC48R / D and UC72R	\$1,410
JCAJUC271/2+10UC27139	Kit of drawers UC27R / D	\$1,177
JCAJUC481/2+10UC48139	Kit of drawers UC48R / D	\$1,198
JCAJUC601/2+10UC60139	Kit of drawers UC60R / D	\$1,206
JCAJUC481/2+10UC72139	Kit of drawers UC72R / D	\$1,206

10. ACCESSORIES & PARTS

# ACCESSORIES & PARTS



## 4" BACKSPLASH

CODE	DESCRIPTION	PRICE \$
ENCCPUC27	4" Backsplash UC27R / F / D	\$376
ENCCPUC48	4" Backsplash UC48R / F / D	\$514
ENCCPUC60	4" Backsplash UC60R / F / D	\$641
ENCCPUC72	4" Backsplash UC72R / F / D	\$721

## NIGHT CURTAINS

CODE	DESCRIPTION	MODELS	PRICE \$
CCNV12 [608N51]	Night curtains VEU12R	VEU12R	\$667
CCNV15 [608N52]	Night curtains VEU15R	VEU15R	\$776
CCNV18 [608N53]	Night curtains VEU18R	VEU18R	\$864

## REAR SLIDING DOORS

CODE	DESCRIPTION	MODELS	PRICE \$
PUEV12CT	Rear sliding doors VEU12R	VEU12R	\$435
PUEV15CT	Rear sliding doors VEU15R	VEU15R	\$588
PUEV18CT	Rear sliding doors VEU18R	VEU18R	\$732

ETL LISTED TO UL471 standard and sanitation classified to NSF / We reserve the right to change specifications without prior notice. Non contractual pictures

## COMPRESSORS

CODE	DESCRIPTION	MODELS	PRICE \$
301D12	Compressor, 3/8 R134a 115V/60Hz	AN23CR, AGB23CR, UC72R, UC72P, UC72PMT, MR67, MR67EN, IMC58SS, IMC58DS, VC1400, VC2010, VC5054, VC5079	\$794
301D16	Compressor, 1/3 R134a 115V/60Hz	AN23, AN49MX, AGB23, AGB23-2, MR41, MR41EN, MPG1980, IMC49SS, IMC49DS	\$807
301D17	Compressor, 1/4 R134a 115V/60Hz	UC48R, UC48P, UC48PMT, UC60R, UC60P, UC60PMT, MPG1490, MSG52, MSG72, MSG96, IMC34SS, IMC34DS, ERV84IISD, ERV84IIGD, VSU63L, VSU63R, VSU77L, VSU77R	\$766
301D18	Compressor, 1-1/4 R404A 208V-230V/60Hz	VAR12H, VAR18H	\$1,023
301D19	Compressor, 1/5 R134a 115V/60Hz	UC27R, UC27P, UC27PMT, MSG48, ERV36IISD, ERV36IIGD, ERV60IISD, ERV60IIGD	\$740
301D20	Compressor, 1/2 R134a 115V/60Hz	AN49, AGB49, AGB49-4, MR93, MR93EN	\$816
301D22	Compressor, 1/8 R134a 115V/60Hz	VSU50L, VSU50R, All VIP Models	\$363
301D25	Compressor, 1/2 R404A 220V/60Hz	VAR15H	\$963
301D32	Compressor, 1-1/4 R404A 115V/60Hz	AN49BT, AGB49BT, ABT71L	\$916
301D36	Compressor, 3/8 R404A 115V/60Hz	UC48F, MR41BT	\$855
301D39	Compressor, 5/8 R134a 115V/60Hz	AN49CR, AN67, AN67CR, AGB49CR	\$850
301D40	Compressor, 1/2 R404A 115V/60Hz	ABT31S, UC60F	\$831
301D41	Compressor, 5/8 R404A 115V/60Hz	AN23BT, AN49MX, AGB23BT, MR67BT	\$910
301D42	Compressor, 3/4 R404A 208V-230V/60Hz	AN67CR, AGN49BT, VAR15H, VAR18H	\$960
301D43	Compressor, 3/4 R404A 115V/60Hz	ABT51L	\$863
301D45	Compressor, 1 R404A 115V/60Hz	AGB23BT, CR	\$1,006
301D48sp2	Compressor, 1/4 R404A 115V/60Hz	UC27F	\$345
301D49	Compressor, 3/4 R134a 115V/60Hz	MR119EN	\$840
301D66	Compressor, 1/2 R404A 115V/60Hz	VBR9R, VBR9SS, VBR9FG, VAR12R, VARAA90R, VEU12R, VEUAA90R	\$376
301D67	Compressor, 3/4 R404A 115V/60Hz	VBR12R, VBR12SS, VBR12FG, VAR15R, VARA-C90R, VEU15R, VEUAC90R	\$848
301D68	Compressor, 1 R404A 115V/60Hz	VBR18R, VBR18SS, VBR18FG, EML9CM1, EML9I-NOXM1	\$857
301D75	Compressor, 1 R404A 220V/60Hz	EML12CM1, EML12INOXM1	\$889
301D77	Compressor, 1-1/4 R404A 220V/60Hz	EML18CM1, EML18INOXM1	\$1,025
301D80	Compressor, 1 R404A 115V/60Hz	VAR18R, VEU18R	\$748
301T04	Compressor, 2 R404A 220V/60Hz	ABT101L	\$1,541
301T05	Compressor, 2-1/2 R404A 220V/60Hz	ABT141L	\$1,545

## DIGITAL CONTROL

CODE	DESCRIPTION	MODELS	PRICE \$
308X05SP2	Electronic Controller, 3 Relays	All Reach-ins, All MR models, All EVV models and MR67Retro, All ERV models	\$330
308X84	EVCO Digital Controller, ABT	All ABT Models	\$633
308UL05	Electronic Controller, XR30CX, 115V/50-60Hz	All VSU Models, All VIP Models, All EML Models	\$330
308UL06	Electronic Controller, 115V/50-60Hz	All MSG Models, All IMC Models	\$330
308UL08	Electronic Controller, 2 Relays	All VC Models	\$330
308UL09	Electronic Controller, XW271L	All VBR Models, All VAR Models	\$330